

Reveal[®] 3-D for Crustacea



DOWNLOAD AND READ KIT INSTRUCTIONS COMPLETELY BEFORE PERFORMING TEST.

Materials Provided:

- 10 pink test devices
- 10 sample tubes and caps
- 10 sachets of Type 8 extraction buffer
- 10 sterile swabs
- 1 bottle swab-wetting solution

700002641 | 902081S

Rinse: 5–10 ppm

Swab: 40 µg/100 cm²

Testing time: 5 minutes

Call 800.234.5333 to order or visit [neogen.com](https://www.neogen.com)

Rinse Sample Extraction



1 Open Type 8 extraction buffer sachet and add to a sample tube.



2 Add 0.25 mL of sample to the sample tube.



3 Secure cap and shake for 1 minute.

Swab Sample Extraction



1 Open Type 8 extraction buffer sachet and add to a sample tube.

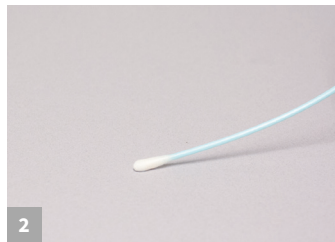

2 For dry surfaces, moisten with swab-wetting solution. Do not premoisten for wet surfaces. Gather the sample.

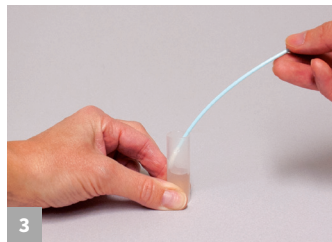

3 Return the swab to the extraction buffer and break off into the tube.



4 Secure cap and shake for 1 minute.

Test Procedure



1 Remove the lid and fill with liquid from the tube.



2 Dip the Reveal 3-D device into the liquid in the lid; ensure that the cavity is saturated with the liquid.



3 Leave the cavity saturated until the liquid is seen running into the test window.



5 Place the device on a flat surface and allow the test to develop for 5 minutes.



5 Interpret the results.

